

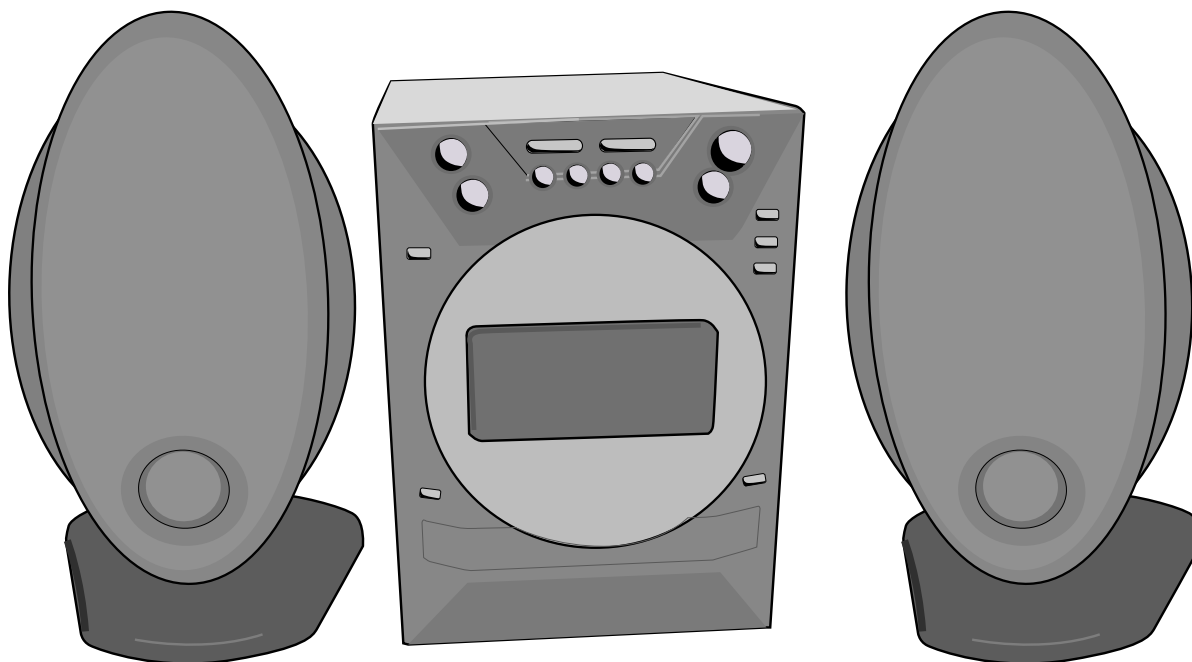

HOME AUDIO SYSTEM WITH CD PLAYER AND AM/FM STEREO RADIO

MODEL: MX3905

**BEFORE OPERATING THIS PRODUCT, PLEASE READ THESE
INSTRUCTIONS COMPLETELY.**



OPERATING INSTRUCTIONS

WARNING

	CAUTION RISK OF ELECTRIC SHOCK DO NOT OPEN	
CAUTION: TO REDUCE THE RISK OF ELECTRIC SHOCK, DO NOT REMOVE COVER (OR BACK). NO USER-SERVICEABLE PARTS INSIDE. REFER SERVICING TO QUALIFIED SERVICE PERSONNEL.		

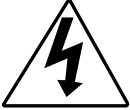

DANGEROUS VOLTAGE:

The lightning flash with arrowhead symbol, within an equilateral triangle is intended to alert the user to the presence of uninsulated dangerous voltage within the product's enclosure that may be of sufficient magnitude to constitute a risk of electric shock to persons.



ATTENTION:

The exclamation point within an equilateral triangle is intended to alert the user to the presence of important operating and maintenance (servicing) instructions in the literature accompanying the appliance.

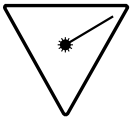

DANGER:

Invisible and hazardous laser radiation when open and interlock failed or defeated. Avoid direct exposure to beam.

FCC WARNING:

This equipment may generate or use radio frequency energy. Changes or modifications to this equipment may cause harmful interference unless the modifications are expressly approved in the instruction manual. The user could lose the authority to operate this equipment if an unauthorized change or modification is made.

SURGE PROTECTORS:

It is recommended to use a surge protector for AC connection. Lightning and power surges ARE NOT covered under warranty for this product.

LASER SAFETY: This unit employs a laser. Only qualified service personnel should attempt to service this device due to possible eye injury.

CAUTION: USE OF CONTROLS, ADJUSTMENTS OR PERFORMANCE PROCEDURE HEREIN MAY RESULT IN HAZARDOUS RADIATION EXPOSURE.

INFORMATION:

This equipment has been tested and found to comply with the limits for a Class B digital device, pursuant to Part 15 of the FCC Rules. These limits are designed to provide reasonable protection against harmful interference in a residential installation. This equipment generates, uses, and can radiate radio frequency energy and, if not installed and used in accordance with the instructions, may cause harmful interference to radio communications. However, there is no guarantee that interference will not occur in a particular installation. If this equipment does cause harmful interference to radio or television reception, which can be determined by turning the equipment off and on, the user is encouraged to try to correct the interference by one or more of the following measures:

- Reorient or relocate the receiving antenna.
- Increase the separation between the equipment and receiver.
- Connect the equipment into an outlet on a circuit different from that to which the receiver is connected.
- Consult the dealer or an experienced radio/TV technician for help.

IMPORTANT SERVICE SAFETY INSTRUCTIONS

Before using the unit, be sure to read all operating instructions carefully. Please note that these are general precautions and may not pertain to your unit. For example, this unit may not have the capability to be connected to an outdoor antenna.

1. READ INSTRUCTIONS

All the safety and operating instructions should be read before the product is operated.

2. RETAIN INSTRUCTIONS

The safety and operating instructions should be retained for future reference.

3. HEED WARNINGS

All warnings on the product and in the operating instructions should be adhered to.

4. FOLLOW INSTRUCTIONS

All operating and use instructions should be followed.

5. CLEANING

Unplug this product from the wall outlet before cleaning. Do not use liquid cleaners or aerosol cleaners. Use a damp cloth for cleaning.

6. ATTACHMENTS

Do not use attachments not recommended by the product's manufacturer as they may cause hazards.

7. WATER AND MOISTURE

Do not use this product near water- for example, near a bathtub, washbowl, kitchen sink, or laundry tub, in a wet basement, or near a swimming pool.

8. ACCESSORIES

Do not place this product on an unstable cart, stand, tripod, bracket, or table. The product may fall, causing serious injury and serious damage to the product. Use only with a cart, stand, tripod, bracket, or table recommended by the manufacturer or sold with the product. Any mounting of the product should follow the manufacturer's instructions, and should use a mounting accessory recommended by the manufacturer.

- 8A. An appliance and cart combination should be moved with care. Quick stops, excessive force, and uneven surfaces may cause the appliance and cart combination to overturn.

PORTABLE CART WARNING
(symbol provided by RETAC)



9. VENTILATION

Slots and openings in the cabinet and in the back or bottom are provided for ventilation and to ensure reliable operation of the product and to protect it from overheating. These openings must not be blocked or covered. The openings should never be blocked by placing the product on a bed, sofa, rug, or other similar surface. This product should never be placed near or over a radiator or heat source. This product should not be placed in a built-in installation such as a bookcase or rack unless proper ventilation is provided or the manufacturer's instructions have been adhered to.

10. POWER SOURCES

This product should be operated only from the type of power source indicated on the marking label. If you are not sure of the type of power supply to your home, consult your appliance dealer or local power company. For products intended to operate from battery power, or other sources, refer to the operating instructions.

11. GROUNDING OR POLARIZATION

This product is equipped with a polarized alternating-current line plug (a plug having one blade wider than the other). This plug will fit into the power outlet only one way. This is a safety feature. If you are unable to insert the plug fully into the outlet, try reversing the plug. If the plug should still fail to fit, contact your electrician to replace your obsolete outlet. Do not defeat the safety purpose of the polarized plug.

12. POWER-CORD PROTECTION

Power-supply cords should be routed so that they are not likely to be walked on or pinched by items placed upon or against them, paying particular attention to cords at plugs, convenience receptacles, and the point where they exit from the appliance.

13. LIGHTNING

To protect your product from a lightning storm, or when it is left unattended and unused for long periods of time, unplug it from the wall outlet and disconnect the antenna or cable system. This will prevent damage to the product due to lightning and power-line surges.

14. POWER LINES

An outside antenna system should not be located in the vicinity of overhead power lines or other electric light or power circuits, or where it can fall into such power lines or circuits. When installing an outside antenna system, extreme care should be taken to keep from touching such power lines or circuits as contact with them might be fatal.

15. OVERLOADING

Do not overload wall outlets and extension cords as this can result in a risk of fire or electric shock.

16. OBJECT AND LIQUID ENTRY

Never push objects of any kind into this product through openings as they may touch dangerous voltage points or short out parts that could result in fire or electric shock. Never spill or spray any type of liquid on the product.

17. OUTDOOR ANTENNA GROUNDING

If an outside antenna is connected to the product, be sure the antenna system is grounded so as to provide some protection against voltage surges and built-up static charges. Section 810 of the National Electric Code, ANSI/NFPA 70, provides information with respect to proper grounding of the mast and supporting structure, grounding of the lead-in wire to an antenna discharge product, size of grounding conductors, location of antenna discharge product, connection to grounding electrodes, and requirements for grounding electrode.

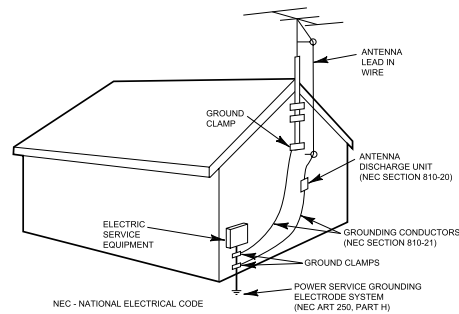

EXAMPLE OF ANTENNA GROUNDING AS PER NATIONAL ELECTRICAL CODE

18. SERVICING

Do not attempt to service this product yourself as opening or removing covers may expose you to dangerous voltage or other hazards. Refer all servicing to qualified service personnel.

19. REPLACEMENT PARTS

When replacement parts are required, be sure the service technician uses replacement parts specified by the manufacturer or those that have the same characteristics as the original part. Unauthorized substitutions may result in fire, electric shock or other hazards.

20. SAFETY CHECK

Upon completion of any service or repairs to this product, ask the service technician to perform safety checks to determine that the product is in proper operating condition.

21. WALL OR CEILING MOUNTING

The product should be mounted to a wall or ceiling only as recommended by the manufacturer.

22. DAMAGE REQUIRING SERVICE

Unplug the product from the wall outlet and refer servicing to qualified service personnel under the following conditions:

- When the power-supply cord or plug is damaged.
- If liquid has been spilled, or objects have fallen into the product.
- If the product has been exposed to rain or water.
- If the product does not operate normally by following the operating instructions. Adjust only those controls that are covered by the operating instructions, as an adjustment of other controls may result in damage and will often require extensive work by a qualified technician to restore the product to its normal operation.
- If the product has been dropped or the cabinet has been damaged.
- When the product exhibits a distinct change in performance - this indicates a need for service.

23. HEAT

The product should be situated away from heat sources such as radiators, heat registers, stoves, or other products (including amplifiers) that produce heat.

24. NOTE TO CATV SYSTEM INSTALLER

This reminder is provided to call the CATV system installer's attention to Article 820-40 of the NEC that provides guidelines for proper grounding and, in particular, specifies that the cable ground shall be connected to the grounding system of the building, as close to the point of cable entry as practical.

PREPARATION FOR USE

AC OPERATION

Unwind the AC power cord and extend it to its full length. Insert the AC power cord into any convenient 120V 60Hz household outlet.

Please note that this unit is equipped with a polarized AC plug which has one blade wider than the other. This is a safety feature to reduce the likelihood of electric shock. This polarized AC plug will only fit in a polarized AC outlet. If you find that you cannot insert this plug into your outlet, you may have an obsolete non-polarized outlet. Please do not try to defeat this safety feature by using a non-polarized adapter or by filing the wider blade to make it fit into your outlet. If this plug does not fit into your outlet, you should contact a qualified licensed electrician to replace your obsolete outlet.

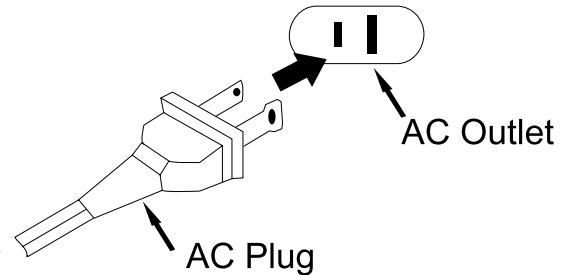

SPEAKER CONNECTION

1. Place the speakers in convenient locations on either side of the unit. Usually a distance of five to eight feet between speakers provides the best stereo effect, but this may vary depending on the size and acoustics of the room.
2. Locate the Speaker Terminals on the rear of the unit and connect the solid black wires to the red (+) terminals and connect the striped wires to the black (-) terminals.
3. To connect the speakers, press the terminal down, insert the speaker wire and press the terminal back to the lock position.
4. Pull lightly on the connection to make sure it is secure.
5. Connect the Speaker Light cable to the Speaker Light jacks. **These will light up the logo and bottom of the speakers.**

CAUTION: Only connect the speakers which are supplied with the unit. The use of any other or additional speakers may cause damage to the unit. Never operate the unit without the speakers connected.

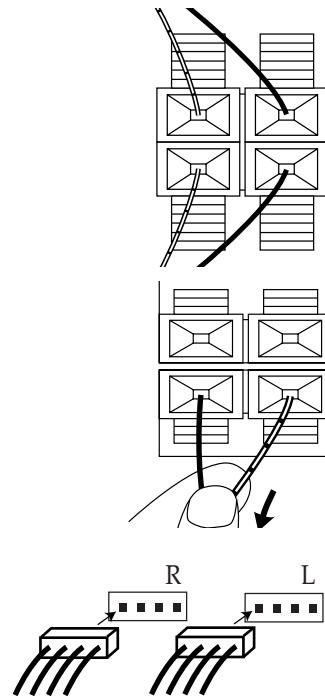

PREPARATION FOR USE (CONTINUED)

BATTERY OPERATION

The battery compartment is located on the rear of the remote control.

- Remove the battery compartment door by pressing down and sliding the door in the direction of the arrow.
- Insert two (2) AA size batteries into the battery compartment as shown to the right. Be sure to observe the polarity markings which are engraved inside the battery compartment. If the batteries are inserted incorrectly, the remote control will not operate.
- Replace the battery compartment door.

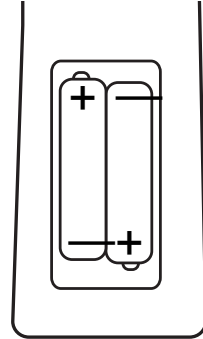

BATTERY PRECAUTIONS

Follow these precautions when using batteries in this device:

1. Use only the size and type of batteries specified.
2. Be sure to follow the correct polarity when installing the batteries as indicated in the battery compartment. Reversed batteries may cause damage to the device.
3. Do not mix different types of batteries together (e.g. Alkaline and Carbon-zinc) or old batteries with fresh ones.
4. If the device is not to be used for a long period of time, remove the batteries to prevent damage or injury from possible battery leakage.
5. Do not try to recharge batteries not intended to be recharged; they can overheat and rupture. (Follow battery manufacturer's directions.)

REMOTE SENSOR:

To operate the unit with the remote control, point the remote at the remote sensor on the front of the main unit and press the appropriate button. The remote control has an effective operating range of approximately 15 feet and an angle of no more than 30°.

NOTE: Bright sunlight may interfere with the operation of the remote control.

LOCATION OF CONTROLS AND INDICATORS

MAIN UNIT

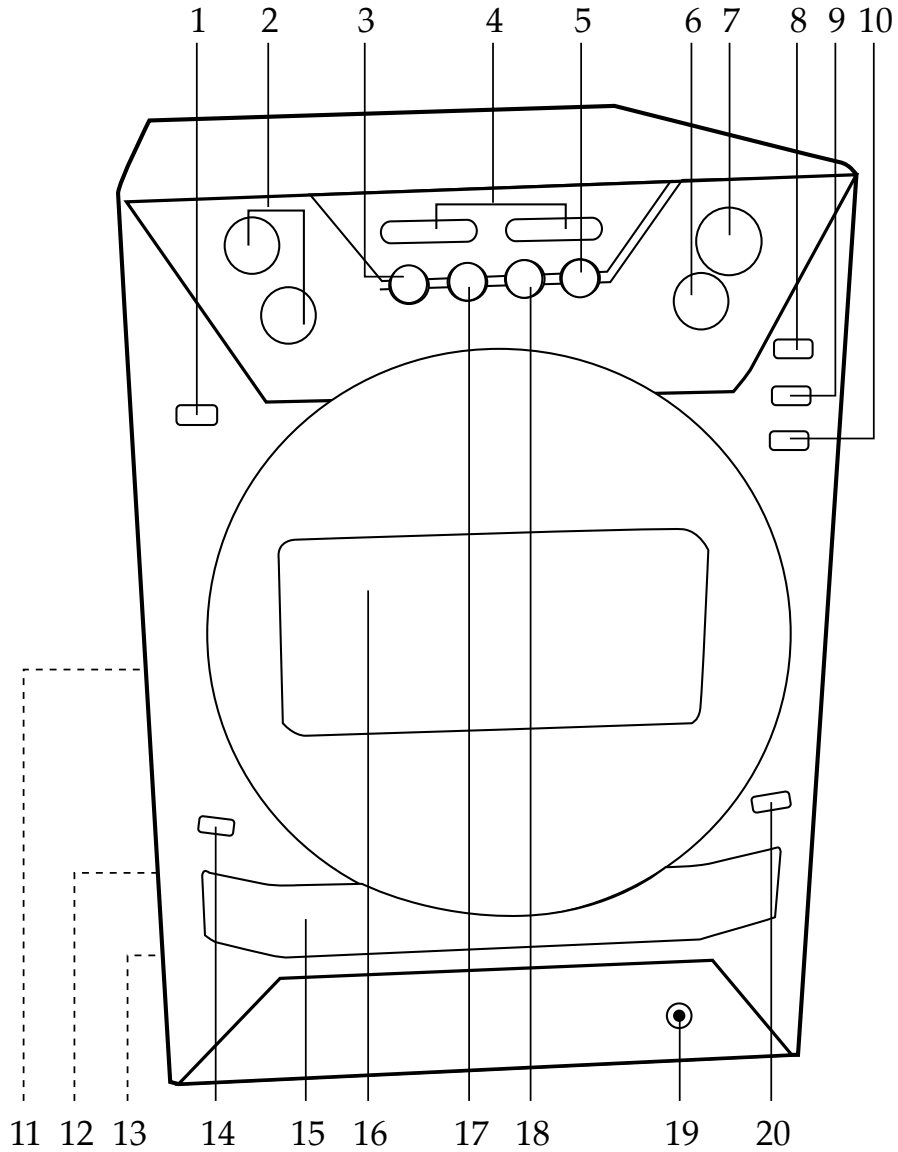

- | | |
|--|--|
| 1. COLOR MODE Button | 11. Speaker/Speaker Light Terminals (Rear of Unit) |
| 2. VOLUME +/- Buttons | 12. AC Cord (Rear of Unit) |
| 3. DISPLAY Button | 13. FM Wire Antenna (Rear of Unit) |
| 4. TUNING/CD Skip/Search ►►/◄◄ Buttons | 14. POWER Button |
| 5. MEMORY/CLOCK SET Button | 15. CD Compartment |
| 6. STOP(■)/BAND Button | 16. Display |
| 7. PLAY/PAUSE (►) Button | 17. RANDOM Button |
| 8. CD Function Button | 18. REPEAT/MEMORY UP Button |
| 9. TUNER Button | 19. Headphones Jack |
| 10. PRESET EQ Button | 20. CD OPEN/CLOSE Button |

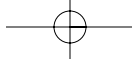

LOCATION OF CONTROLS AND INDICATORS

REMOTE

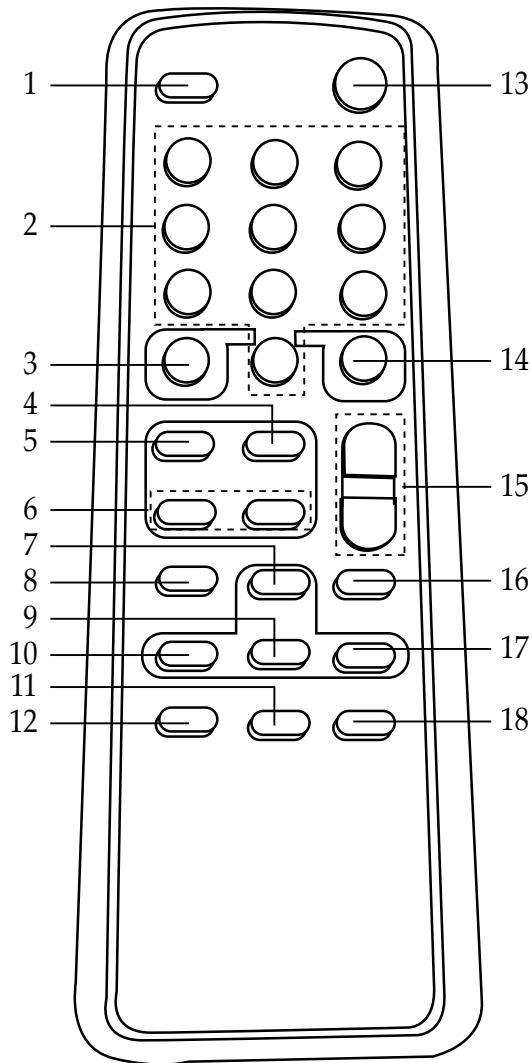

- | | |
|--|---|
| <ol style="list-style-type: none"> 1. FUNCTION Button 2. Direct Track Selection Buttons 3. OVER Button 4. PLAY/PAUSE Button 5. STOP/BAND Button 6. TUNING DN/UP Buttons 7. RANDOM Button 8. DISPLAY Button 9. INTRO Button 10. REP (Repeat)/MEM (Memory Up) Button | <ol style="list-style-type: none"> 11. SNOOZE Button 12. TIMER Button 13. POWER Button 14. MUTE Button 15. VOLUME +/- Buttons 16. PRESET EQ Button 17. MEM (Memory)/CLOCK Button 18. SLEEP Button |
|--|---|

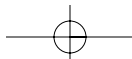

OPERATING INSTRUCTIONS

SETTING THE CLOCK

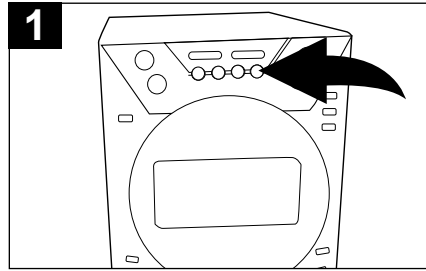

1 With the power off, press and hold the MEMORY/CLOCK SET button; "24H" will blink.

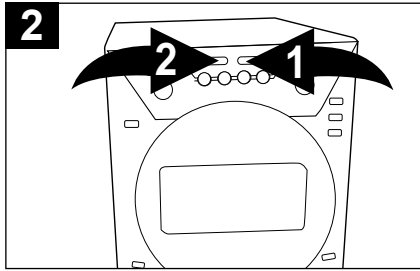

2 Press the TUNING/CD Skip/Search ►► **1** or ◄◄ **2** button to set the unit to the 24 hour (24H) mode (also known as military time), or 12 hour (12H) mode.

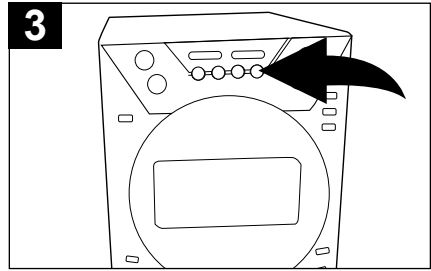

3 Press the MEMORY/CLOCK SET button and the hours will blink.

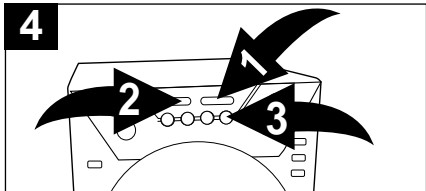

4 Press the TUNING/CD Skip/Search ►► **1** or ◄◄ **2** button to set the current hour, then press the MEMORY/CLOCK SET button **3** again; the minute digits will blink. If you selected 12H time display be sure to observe the AM or PM indicators to make sure you have set the hour correctly.

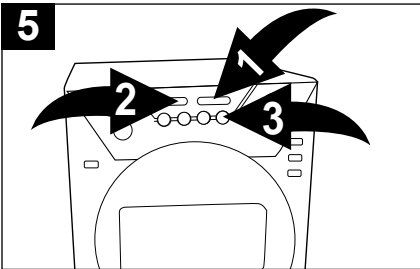

5 Press the TUNING/CD Skip/Search ►► **1** or ◄◄ **2** button to set the current minute. Press the MEMORY/CLOCK SET button **3** and the time will be set.

OPERATING INSTRUCTIONS (CONTINUED)

DISPLAY BUTTON (REMOTE CONTROL ONLY)

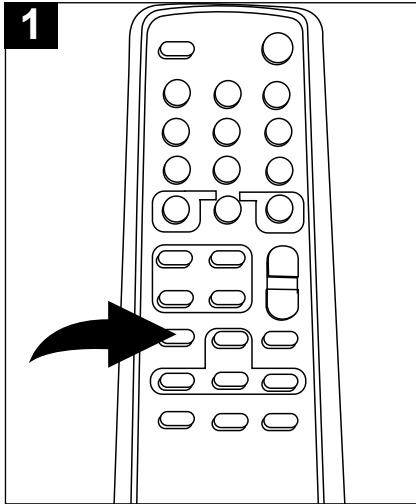

Standby (Power Off) Mode

In Standby (Power Off) mode the display shows the correct time. Press the DISPLAY button once to show the TIMER ON time. After five seconds the display returns to the correct time.

Tuner Mode

In Tuner mode the display shows a radio frequency. Press the DISPLAY button once to show the correct time, or twice to show the TIMER ON time. After five seconds the display returns to the correct time.

CD Mode

In CD mode the display shows the CD track number and elapsed time. Press the DISPLAY button once to see the Remaining Time on the disc, twice to see the correct time, and a third time to see the TIMER ON time. After five seconds the display returns to the correct time.

CHANGING THE LIGHTING IN THE DISPLAY

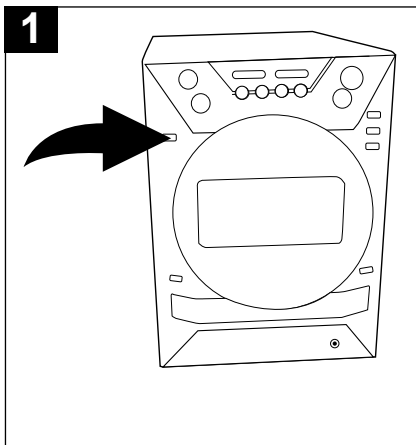

When the unit is first turned on, the display will slowly cycle through all the colors. Press the COLOR MODE button when the desired color appears and that color will remain. To begin the cycling of the colors, press the COLOR MODE button again.

Press and hold the COLOR MODE button, then release and the color will change one by one. Press the COLOR MODE button again when the desired color appears and the color will remain. Press the COLOR MODE button repeatedly, the color will change by each press. Press and hold the COLOR MODE button then release, the display will slowly cycle through all colors again."

PRESET EQ

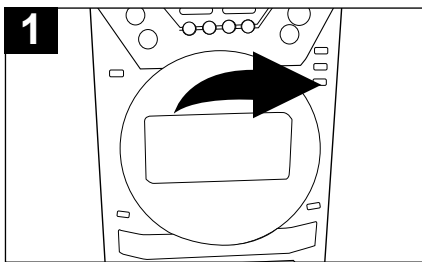

Press the PRESET EQ button to cycle through the preset EQ settings, or to turn the EQ off. Each press of the PRESET EQ button will cycle as follows: CLASSIC (harp), ROCK (guitar) POP (dancing), Off.

HEADPHONE JACK

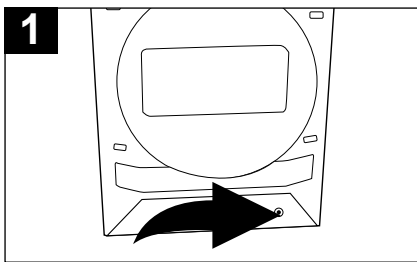

To listen to the unit through headphones, simply insert the headphones (not included) into the Headphones jack. The speakers will be disconnected when the headphones are plugged in.

OPERATING INSTRUCTIONS (CONTINUED)

LISTENING TO THE RADIO

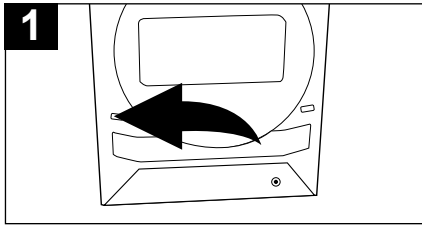

1 Press the POWER button to turn the unit on.

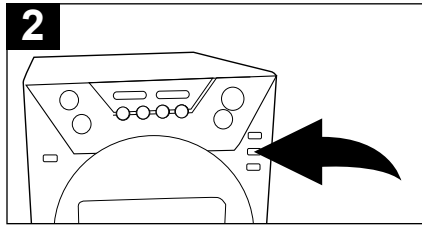

2 Press the TUNER button; "TUNER" will appear in the display.

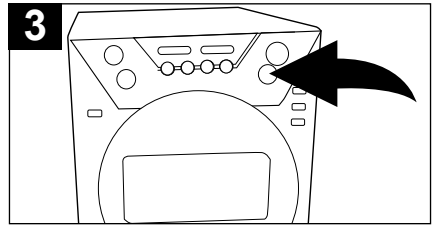

3 Press the STOP (■)/BAND button to select AM or FM.
NOTE: If you select the FM band, be sure to extend the FM Wire Antenna.

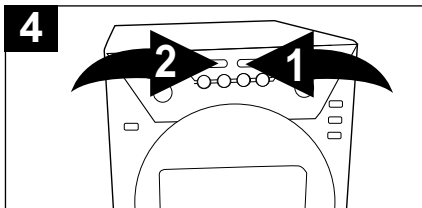

4 Press the TUNING/CD Skip/Search ►► ❶ or ◀◀ ❷ button to select a station (see Tuning note below).
NOTE: If the FM band is selected and you have tuned to an FM Stereo station, the FM Stereo indicator will light in the display.

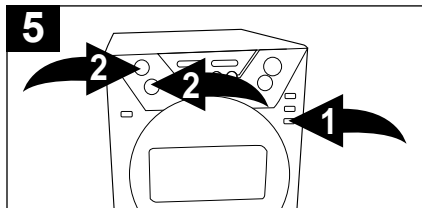

5 Adjust the PRESET EQ ❶ and VOLUME ❷ buttons as desired.

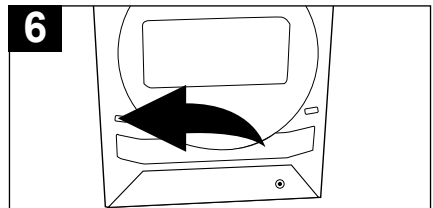

6 When you have finished listening, press the POWER button to turn the unit off.

TUNING:

MANUAL TUNING: Repeatedly press the TUNING/CD Skip/Search ►► or ◀◀ to manually advance the frequency in the display up or down until the desired frequency appears.

AUTOMATIC TUNING: Press and hold the TUNING/CD Skip/Search ►► or ◀◀ until the frequency in the display starts to scan, and then release the button; the tuner will search and then stop on the next strong station it finds. Repeat this procedure until the desired frequency appears in the display.

Hints for Better Reception

FM - Make sure that the FM Wire Antenna is extended to its full length. You may have to vary the direction of the antenna to find the strongest signal for each FM station.

AM - The AM ferrite bar antenna is located inside the unit. It may be necessary to turn the unit slightly so that the internal antenna is pointing in the direction of the AM transmitter. You may have to experiment to find the position that provides the strongest reception for each of your favorite AM stations.

MUTE

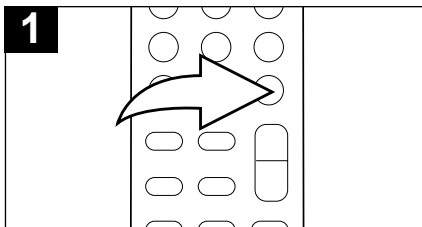

1 To temporarily mute the sound, press the MUTE button on the remote control; the Mute indicator will appear in the display and the sound will be muted. Press the MUTE button again to restore the sound and the Mute indicator will disappear from the display.

OPERATING INSTRUCTIONS (CONTINUED)

SETTING RADIO PRESETS

This unit can preset 10 AM and 10 FM radio stations for convenient recall.

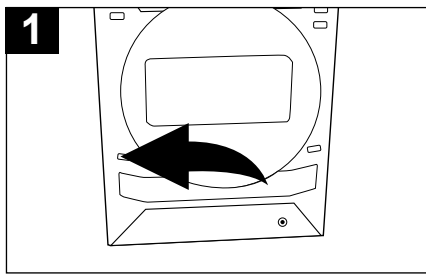
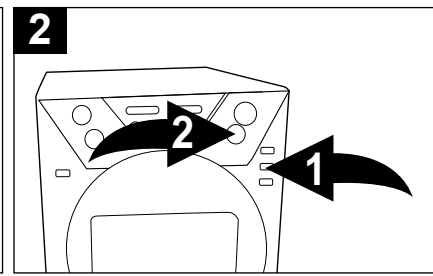
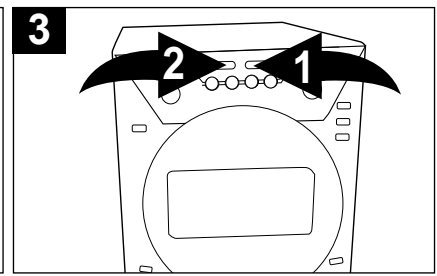
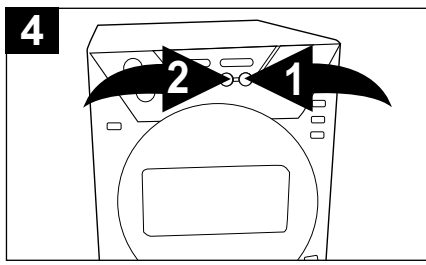
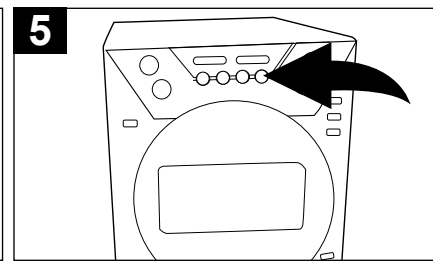
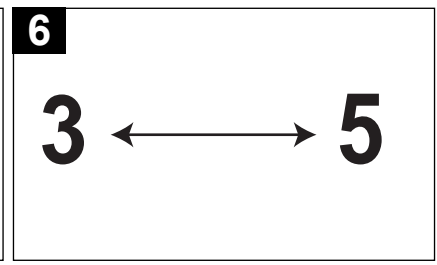
		
<p>Press the POWER button to turn the unit on.</p>	<p>Press the TUNER button ❶; "TUNER" will appear in the display. Press the STOP (■)/BAND button ❷ to select the desired band - FM or AM.</p>	<p>Use the TUNING/CD Skip/Search ►► ❶ or ◀◀ ❷ button to select a station.</p>
		
<p>Press the MEMORY/CLOCK SET button ❶. Within four seconds, press the REPEAT/MEMORY UP button ❷ until the desired memory number appears on the display.</p>	<p>Press the MEMORY/CLOCK SET button again to set the station in the selected memory.</p>	<p>Repeat steps 3 through 5 to program up to 10 stations in each band, if desired. In case the main power supply is interrupted, the memory presets will be erased.</p>

RECALLING RADIO PRESETS

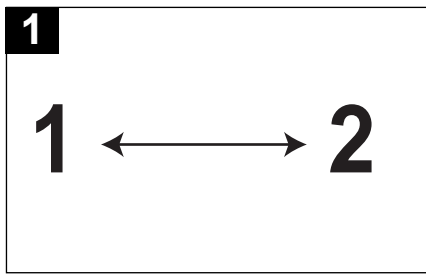
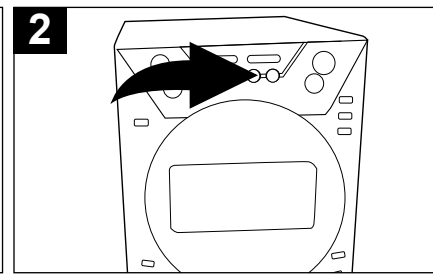
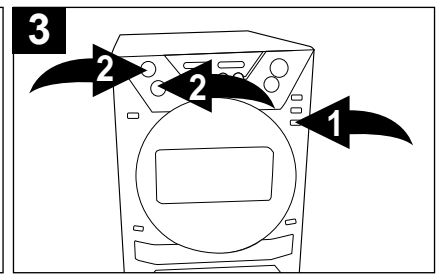
		
<p>Follow steps 1 and 2 above.</p>	<p>Press the REPEAT/MEMORY UP button to select a preset; the station will automatically be tuned in.</p>	<p>Adjust the PRESET EQ ❶ and VOLUME ❷ buttons as desired.</p>

OPERATING INSTRUCTIONS (CONTINUED)

PLAYING COMPACT DISCS NORMAL PLAYBACK

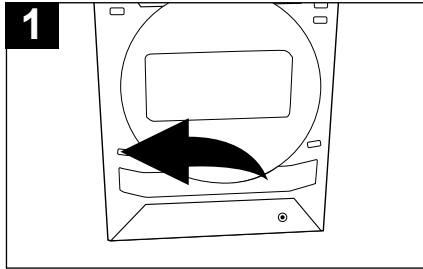

1 Press the **POWER** button to turn the unit on.

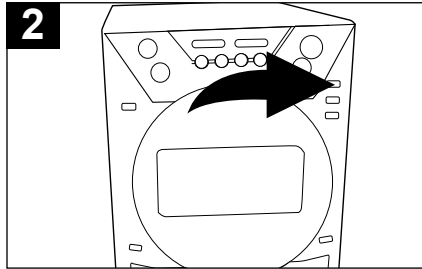

2 Press the **CD Function** button to select CD.

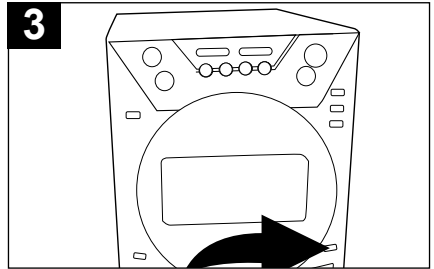

3 Press the **CD OPEN/CLOSE** button to open the CD Compartment and insert a CD with the label side facing up. Press again to shut the CD Compartment.

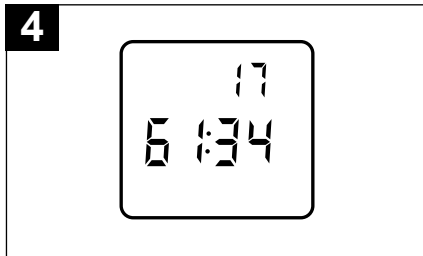

4 The CD player will read the table of contents on the disc and the total number of tracks and total playing time on the disc will appear in the display.

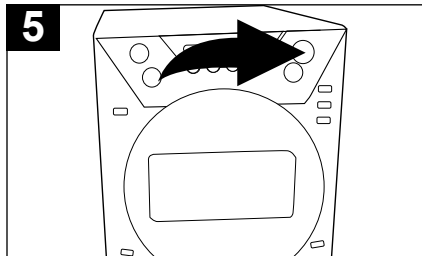

5 Press the **PLAY/PAUSE (▶||)** button to begin playback on Track 1.

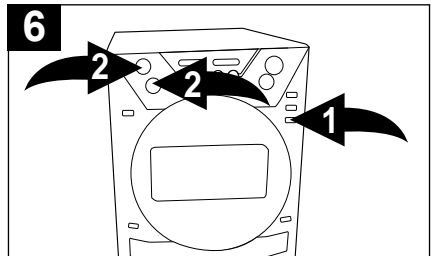

6 Adjust the **PRESET EQ ①** and **VOLUME ②** buttons as desired. Playback will continue until all the tracks on the disc have been played.

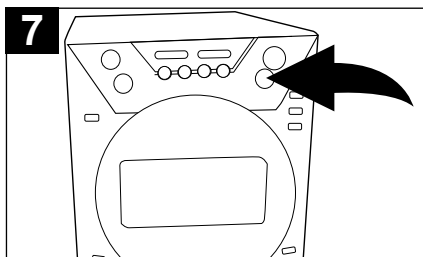

7 To stop playback before the disc ends, press the **STOP (■)/BAND** button. The disc will stop and the display will show the total number of tracks and playing time on the disc.

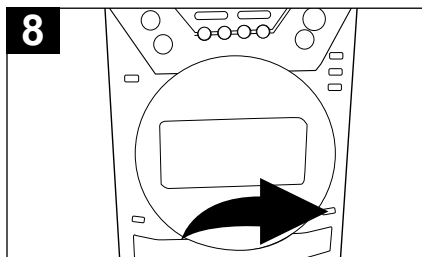

8 After the last track has been played, the disc stops automatically and the display shows the total number of tracks and playing time on the disc. If you are finished listening, press the **CD OPEN/CLOSE** button to eject the CD Compartment.

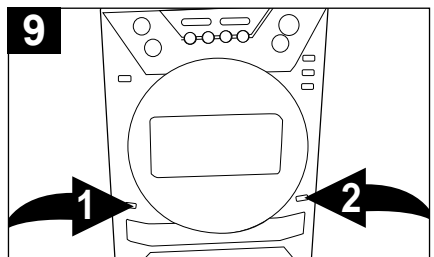

9 Remove your disc and press the **CD OPEN/CLOSE** button ① to close the CD Compartment, then press the **POWER** button ② to turn the unit off.

OPERATING INSTRUCTIONS (CONTINUED)

CD PAUSE CONTROL

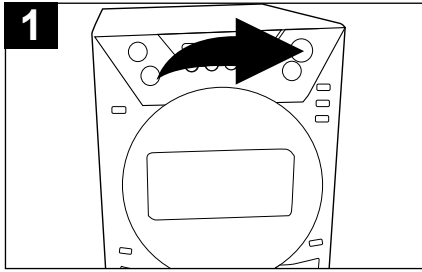

1 During CD playback, if you wish to pause the disc momentarily, press the PLAY/PAUSE (▶||) button again. Playback stops but the disc continues to spin and the time display will blink.

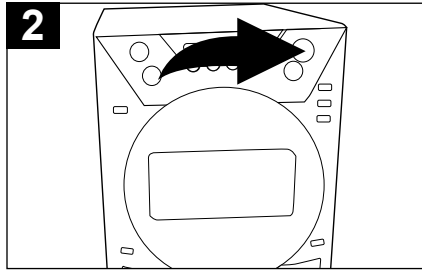

2 Press the PLAY/PAUSE (▶||) button again to release pause and resume normal CD playback.

TO BEGIN PLAYBACK FROM A SPECIFIC TRACK

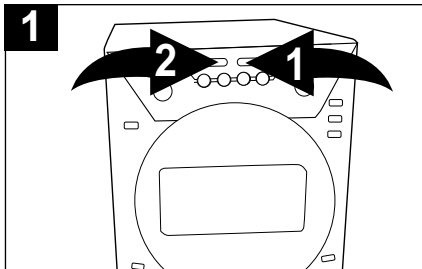

1 After you insert the disc into the CD player and the total number of tracks appear on the display, you may press either the CD Skip/Search (▶▶) (1) or (◀◀) (2) button to select a specific track for playback.

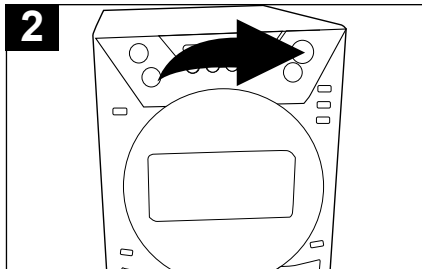

2 When the desired track number appears in the display, press the PLAY/PAUSE (▶||) button. Playback will begin on the track you selected.

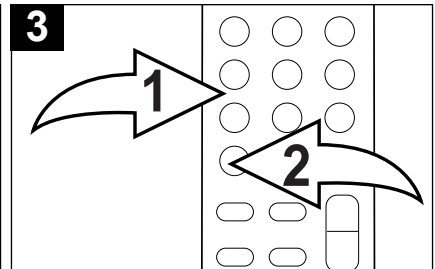

3 You can also use the Direct Track Selection buttons (1) on the remote to directly select a track. If the track is over 9, press the OVER button (2) first. Playback will start automatically.

FORWARD/REVERSE SKIP TRACK AND HIGH-SPEED MUSIC SEARCH (▶▶/◀◀)

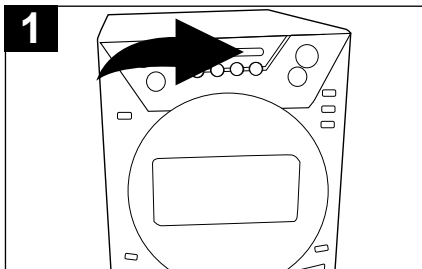

1 During playback, press the CD Skip/Search (▶▶) button once to advance the player to the beginning of the next track. Press the CD Skip/Search (▶▶) button repeatedly to advance the player to higher numbered tracks.

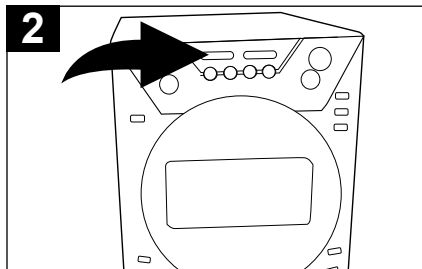

2 During playback, press the CD Skip/Search (◀◀) button once to move the player back to the beginning of the current track. Press the CD Skip/Search (◀◀) button repeatedly to move the player back to lower numbered tracks.

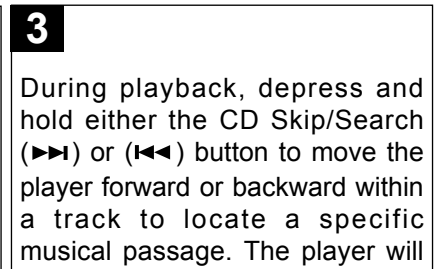

3 During playback, depress and hold either the CD Skip/Search (▶▶) or (◀◀) button to move the player forward or backward within a track to locate a specific musical passage. The player will move forward or backward at high speed as long as the button is depressed. When you release the CD Skip/Search (▶▶) or (◀◀) button, normal playback will resume.

OPERATING INSTRUCTIONS (CONTINUED)

REPEAT PLAYBACK

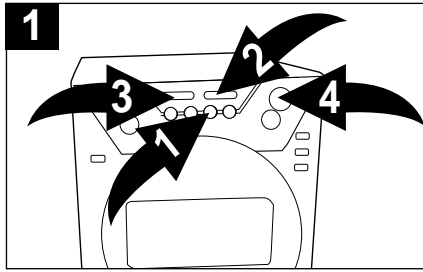

To repeat a single track, while in the Stop mode, press the REPEAT/MEMORY UP button ❶ once; "REPEAT" will blink in the display. Press the CD Skip/Search ►► ❷ or ◀◀ button ❸ to select the specific track that you wish to repeat. When the desired track number appears in the display, press the PLAY/PAUSE (►||) button ❹ to begin playback. The specific track you selected will be repeated continuously.

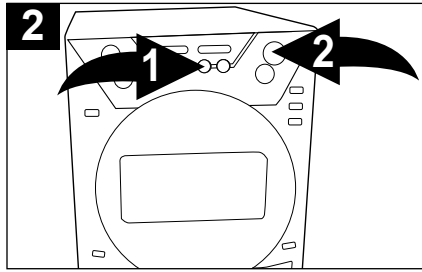

To repeat all of the tracks on a disc continuously, while in the Stop mode, press the REPEAT/MEMORY UP button ❶ twice; "REPEAT" will light in the display. Press the CD PLAY/PAUSE (►||) button ❷ to begin all tracks repeat.

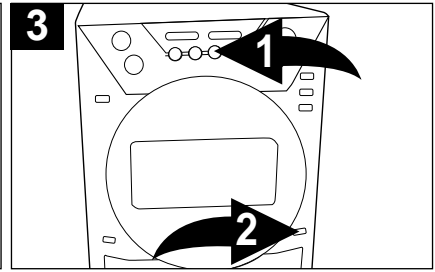

To cancel Repeat Playback, press the REPEAT/MEMORY UP button ❶ until "REPEAT" disappears from the display. You can also cancel Repeat Playback by pressing the CD OPEN/CLOSE button ❷.

PROGRAMMED PLAYBACK

The CD player in this unit has a 20 track programmable memory that allows you to program up to 20 tracks on any disc for playback in any desired order. You may program 20 different tracks or you may also program certain tracks to play more than once.

To perform programmed playback, proceed as follows:

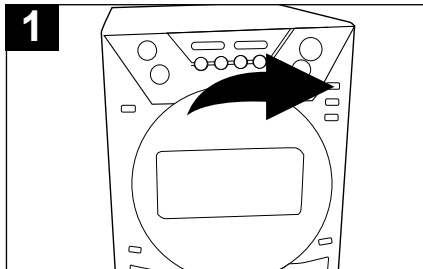

Press the CD Function button to select CD.

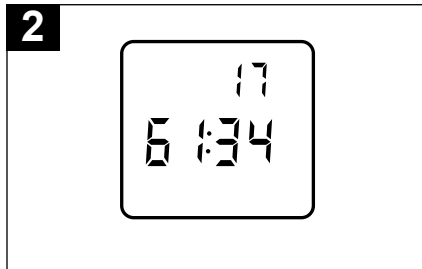

Insert a CD with the label side facing up. Wait for the CD player to read the table of contents and display the total number of tracks and playing time of the disc.

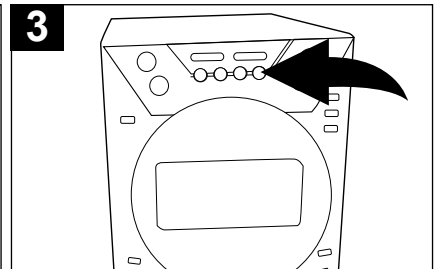

Press the MEMORY/CLOCK SET button; "P-01" (program number), "00" (track number) will appear and "MEMORY" will appear in the display.

PROGRAMMED PLAYBACK SECTION CONTINUED ON NEXT PAGE.

OPERATING INSTRUCTIONS (CONTINUED)

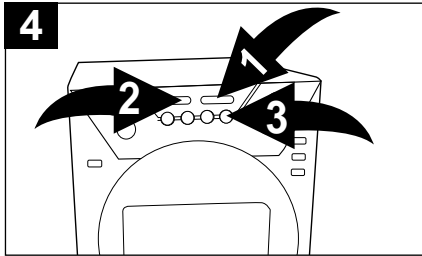

4 Press the CD Skip/Search **▶▶** **1** or **◀◀** button **2** to select the first track that you wish to program. When the desired track number appears in the display, press the MEMORY/CLOCK SET button **3** again.

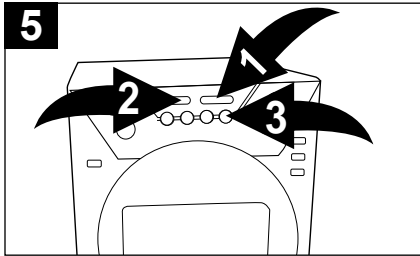

5 Press either the CD Skip/Search (**▶▶**) **1** or (**◀◀**) button **2** to select the next track you wish to program. When the desired track number appears in the display, press the MEMORY/ CLOCK SET button **3** again.

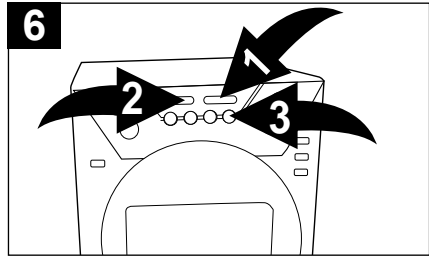

6 Repeat step 5 until you have programmed up to 20 track numbers into the CD Program Memory.

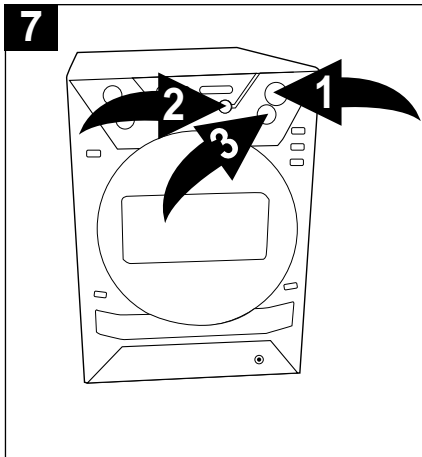

7 After programming up to 20 tracks in the CD Program Memory, press the PLAY/PAUSE (**▶||**) button **1** to begin programmed playback. "MEMORY" will appear in the display and playback will begin on the first track that you programmed. The player will continue to play all of the tracks that you programmed in the order in which you programmed them. When the last programmed track has been played, the player will stop and the display will again show the total number of tracks and playing time on the disc. If you press the MEMORY/CLOCK SET button **2** and then press the PLAY/PAUSE (**▶||**) button **1** again, playback will start on the first track you programmed and will continue until all the programmed tracks have been played. To cancel the Programmed Playback mode, press the MEMORY/CLOCK SET button **2** to enter the program mode, and then press the STOP (**■**)/BAND button **3** twice.

PROGRAMMED REPEAT

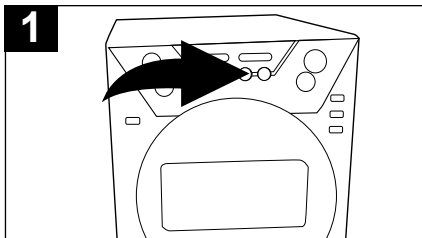

1 It is also possible to use the Program and Repeat functions together to repeat a specific program indefinitely. First, program the tracks you wish to hear in the order you wish to hear them, as described above. Then, press the REPEAT/MEMORY UP button twice. Both the MEMORY and REPEAT indicators will appear in the display.

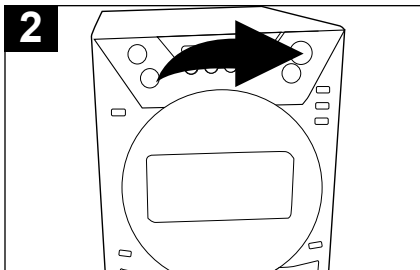

2 Press the PLAY/PAUSE (**▶||**) button to begin programmed repeat playback. The player will play the tracks you selected in the order in which you programmed them. When the last track in the program has been played, the entire program will begin again.



3 Programmed Repeat operation will continue indefinitely until you press the STOP (**■**)/BAND button.

OPERATING INSTRUCTIONS (CONTINUED)

RANDOM PLAYBACK

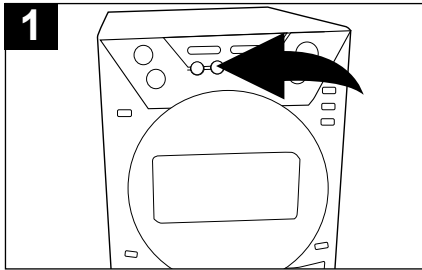

To play the tracks on the CD in a random order, while in the Stop mode, press the RANDOM button. Playback will start automatically and all the tracks will play in a random order.

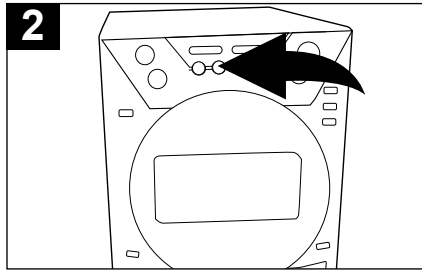

To cancel random playback, press the RANDOM button until "RANDOM" disappears from the display.

INTRO PLAYBACK

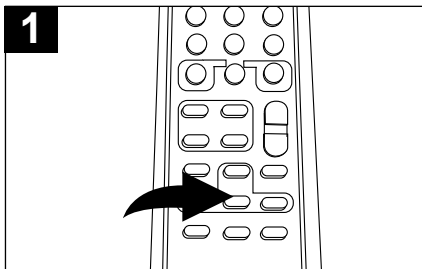

To play the first 10 seconds of each track on the CD, press the INTRO button. Playback will start automatically and will play 10 seconds of each track.

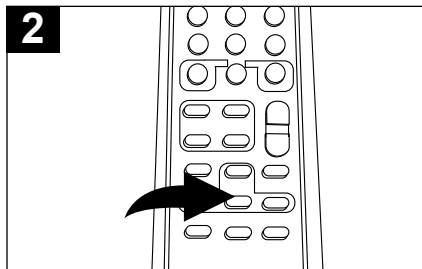

To cancel intro playback, press the INTRO button until "INTRO" disappears from the display; playback will continue from that point.

OPERATING INSTRUCTIONS (CONTINUED)

SETTING THE TIMER

Set the timer to turn the unit on to the Tuner or CD mode at a preset time as follows :

NOTE: Please make sure the volume is set to the desired level to wake you up.

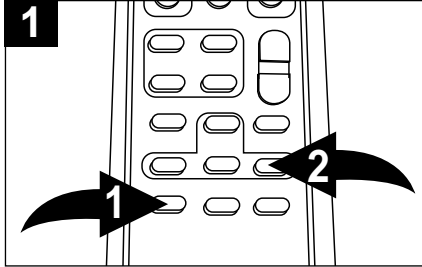

With the power off, press the TIMER button ❶; "TIMER" will blink in the display. Press and hold the MEM/ CLOCK button ❷ until the Timer Hour blinks in the display.

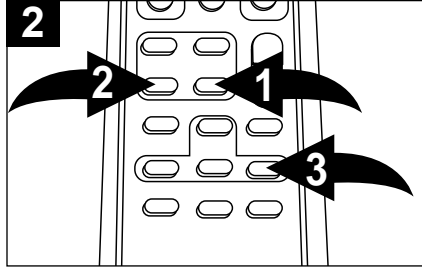

Press the CD Skip/Search ►► ❶ or ◄◄ ❷ button to set the hour, then press the MEMORY/ CLOCK SET button ❸ again; the minute digits will blink. Press the CD Skip/Search ►► ❶ or ◄◄ ❷ button to set the minutes, then press the MEM/CLOCK button ❸ again.

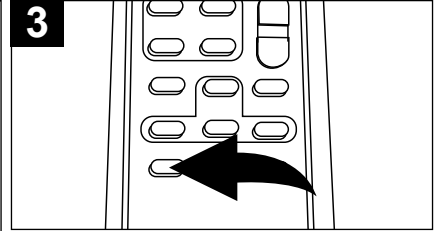

Within a few seconds, "TIMER" will light in the display to indicate that the timer is set. When the actual time matches the time set for the Timer, the unit will turn on to the last function (CD or tuner) used. It will play for one hour (in the Tuner mode) or to the end of the disc (in the CD mode) and then shut off and reset itself for the following day.

TO TURN THE TIMER OFF SO IT IS NOT SET FOR THE NEXT DAY, press and hold the TIMER button again until "TIMER" disappears from the display.

SNOOZE

The timer can be temporarily turned off manually by pressing the SNOOZE button; the timer will turn back on automatically nine minutes later.

ACTIVATING THE SLEEP FUNCTION

Set the sleep timer as follows:

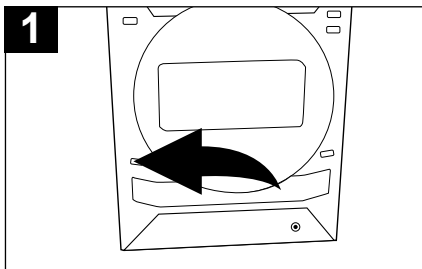

Press the POWER button to turn the unit on and tune the desired radio station or insert a CD as previously instructed.

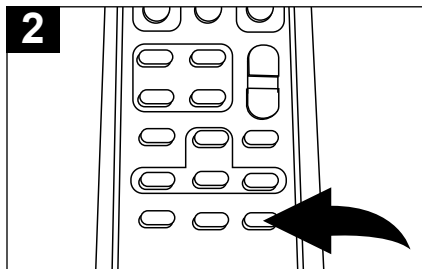

Press the SLEEP button and "90" will appear and "SLEEP" will blink in the display.

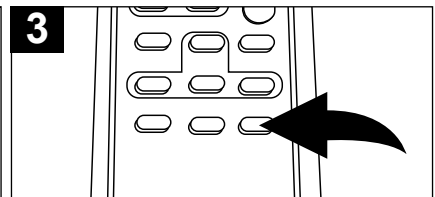

Press the SLEEP button a second time to set the unit to turn off after 80 minutes. Each additional press will decrease the sleep time by 10 minutes. After the sleep time is set, the SLEEP Indicator will light in the display after five seconds, then you can press the SLEEP button at any time to stop the Sleep function; "SLEEP" will disappear from the display.

CARE AND MAINTENANCE

Caring for Compact Discs

- Treat the compact disc carefully. Handle the compact disc only by its edges. Never allow your fingers to come in contact with the shiny, unprinted side of the compact disc.
- Do not attach adhesive tape, stickers, etc. to the compact disc label.
- Clean the compact disc periodically with a soft, lint-free, dry cloth. Never use detergents or abrasive cleaners to clean the compact disc. If necessary, use a CD cleaning kit.
- If a compact disc skips or gets stuck on a section of the compact disc, it is probably dirty or damaged (scratched).
- When cleaning the compact disc, wipe in straight lines from the center of the compact disc to the outer edge of the compact disc. Never wipe in circular motions.

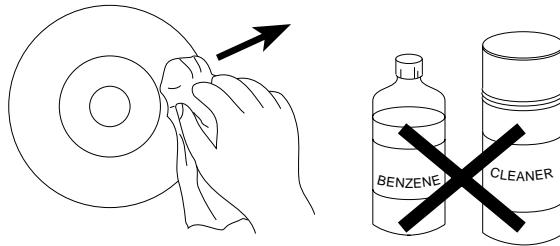
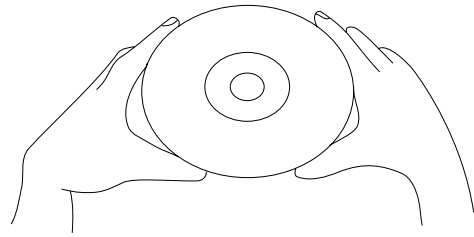

- This unit is designed to play only compact discs bearing the identification logo as shown here. Other compact discs may not conform to the CD standard and may not play properly.
- Compact discs should be stored in their cases after each use to avoid damage.
- Do not expose compact discs to direct sunlight, high humidity, high temperatures, or dust, etc. Prolonged exposure or extreme temperatures can warp the compact disc.
- Do not stick or write anything on either side of the compact disc. Sharp writing instruments, or the ink may damage the surface.



TROUBLESHOOTING GUIDE

Should this unit exhibit a problem, check the following before seeking service:

Symptom	Possible Cause	Solution
Radio		
Noise or sound distorted on radio broadcasts.	Station not tuned properly for AM or FM.	Retune the AM or FM broadcast station.
	FM: Wire Antenna is not extended.	Extend FM Wire Antenna.
	AM: Unit is not positioned correctly.	Rotate unit until best reception is obtained.
FM STEREO indicator does not light.	Poor FM signal being received.	Retune station or try another station that broadcasts in stereo.
	Station is not broadcasting in stereo.	Change stations.
AM or FM, no sound.	TUNER button is not pressed.	Press the TUNER button to select Tuner.
	Volume at minimum.	Increase volume.
Compact Disc Player		
CD Player will not play.	CD function is not selected.	Press the CD Function button to select CD.
	CD is not installed or installed incorrectly.	Insert CD with label facing up.
CD skips while playing.	Disc is dirty or scratched.	Wipe disc with cloth or use another disc.
General		
No power.	AC power cord is not connected.	Connect AC power cord.
Remote not working.	Batteries not inserted, or inserted incorrectly.	Insert batteries correctly.

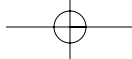

**FOR ADDITIONAL SET-UP OR OPERATING ASSISTANCE, PLEASE VISIT OUR WEBSITE AT
WWW.MEMOREXELECTRONICS.COM
OR CONTACT CUSTOMER SERVICE AT 1-800-919-3647.**

**PLEASE KEEP ALL PACKAGING MATERIAL FOR AT LEAST 90 DAYS IN CASE YOU NEED
TO RETURN THIS PRODUCT TO YOUR PLACE OF PURCHASE OR MEMOREX.**

FOR PARTS AND ACCESSORIES, CONTACT FOX INTERNATIONAL AT 1-800-321-6993.

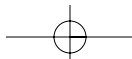

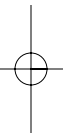
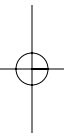
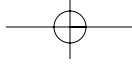

Memcorp, Inc.
Weston, FL
Printed in Hong Kong

Visit our website at www.memorexelectronics.com

